



guardians of drinking water quality

## ASSISTING THE RISK ASSESSMENT

To help aid the risk assessment process, and potentially costs to the relevant person, information regarding the private water supply can be collected before the visit of the local authority.

This information can include the following:

- Installation Records
- Maintenance Diaries
- Supply Plans
- Treatment System Schematics
- On-site Measurements
- System Checks

Some examples of the detail required for the risk assessment are outlined below:

### 1. Supply Plans

Borehole schematic outlining pipework, treatment processes and relevant information regarding the supply system

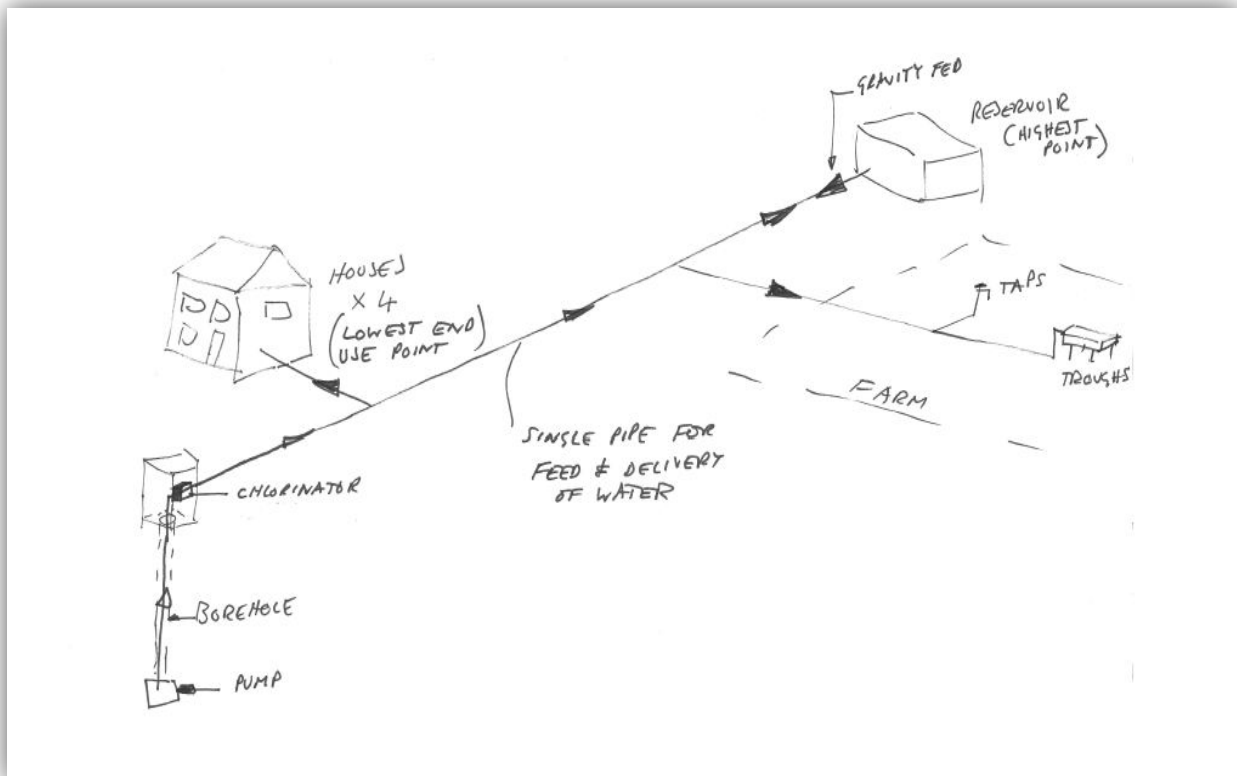

Schematic of a spring system that includes relevant information regarding the individual components of the supply and steps to take in the event of no water

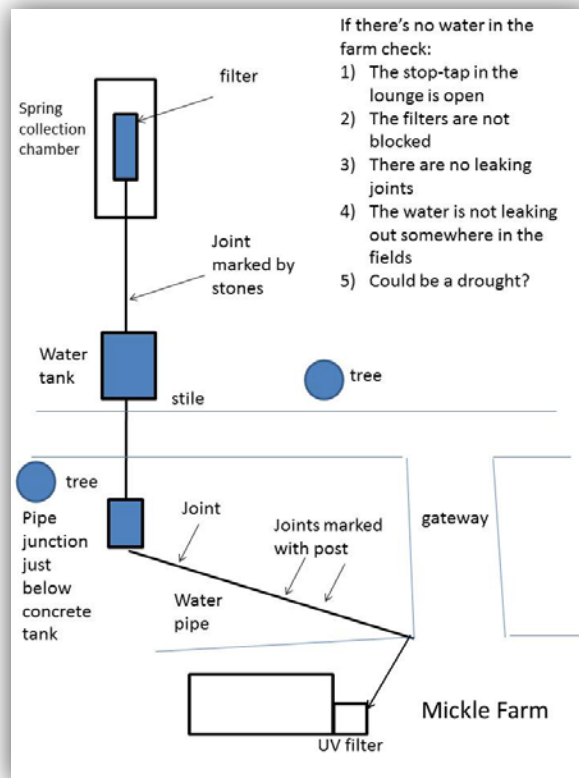

WHO Schematic showing the wider catchment of the supply whilst still highlighting relevant information about the supply

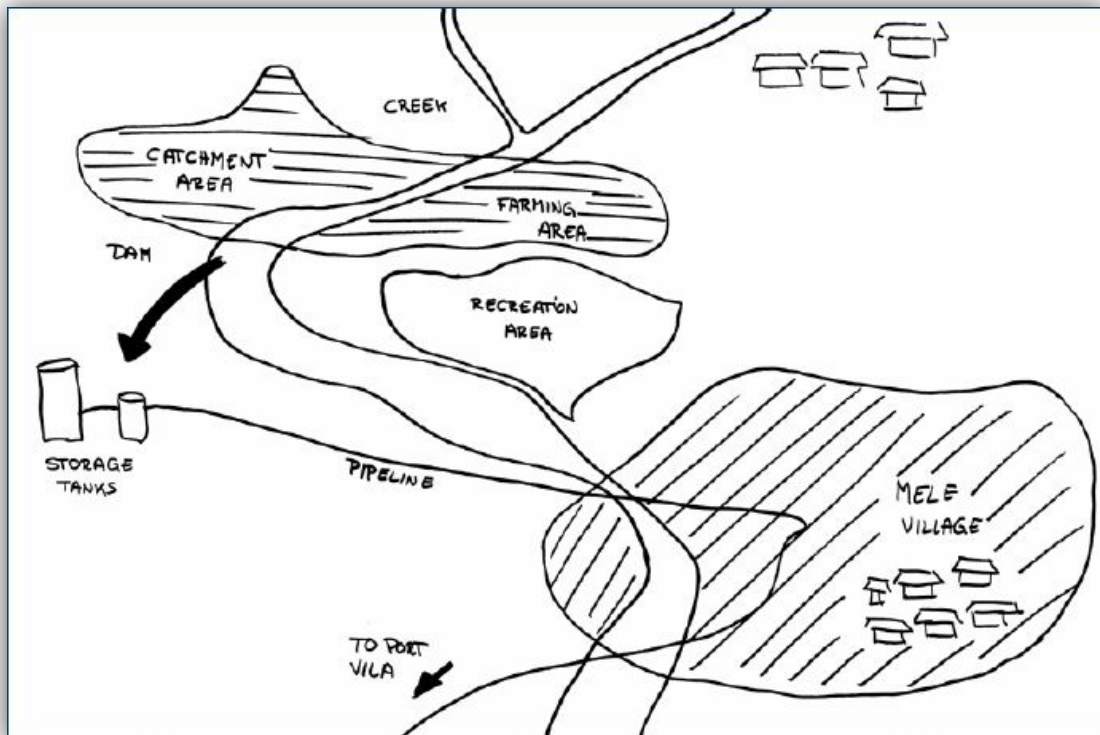

## 2. TREATMENT SYSTEMS

Full building schematic showing components of the chlorination unit

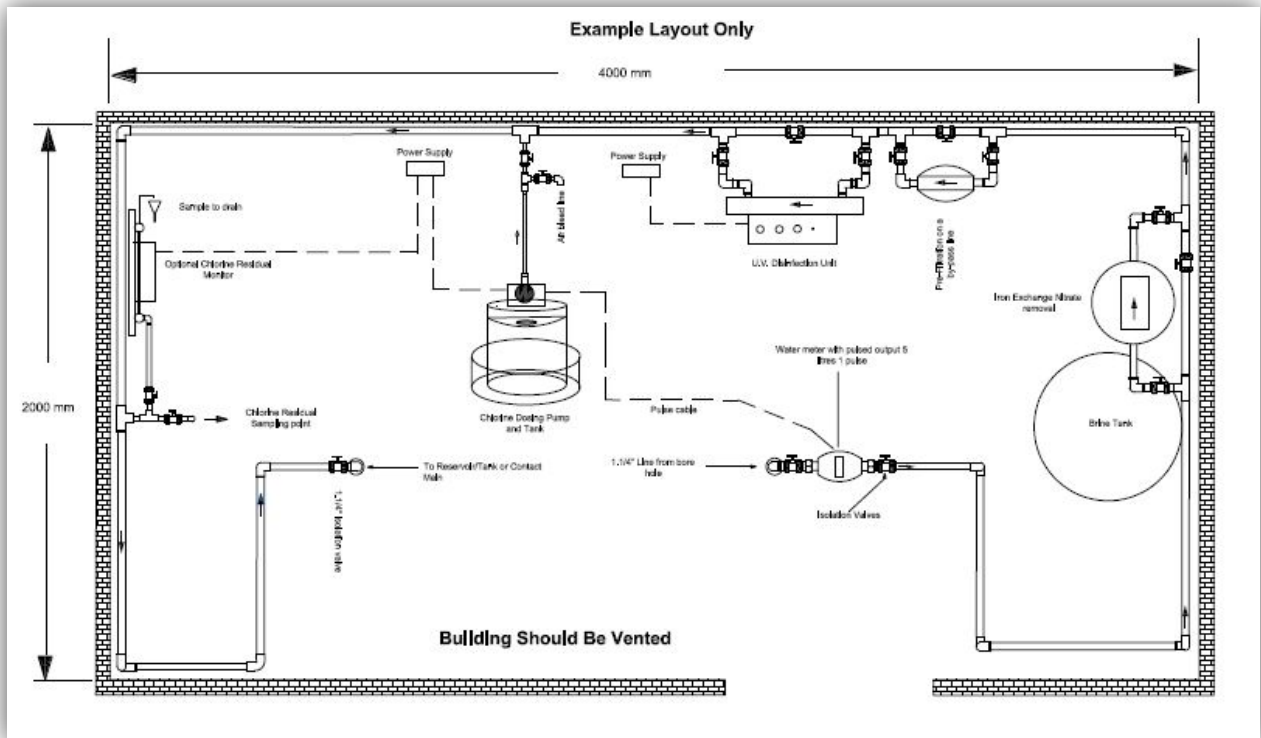

Full building schematic showing components of the an UV unit and a pH unit

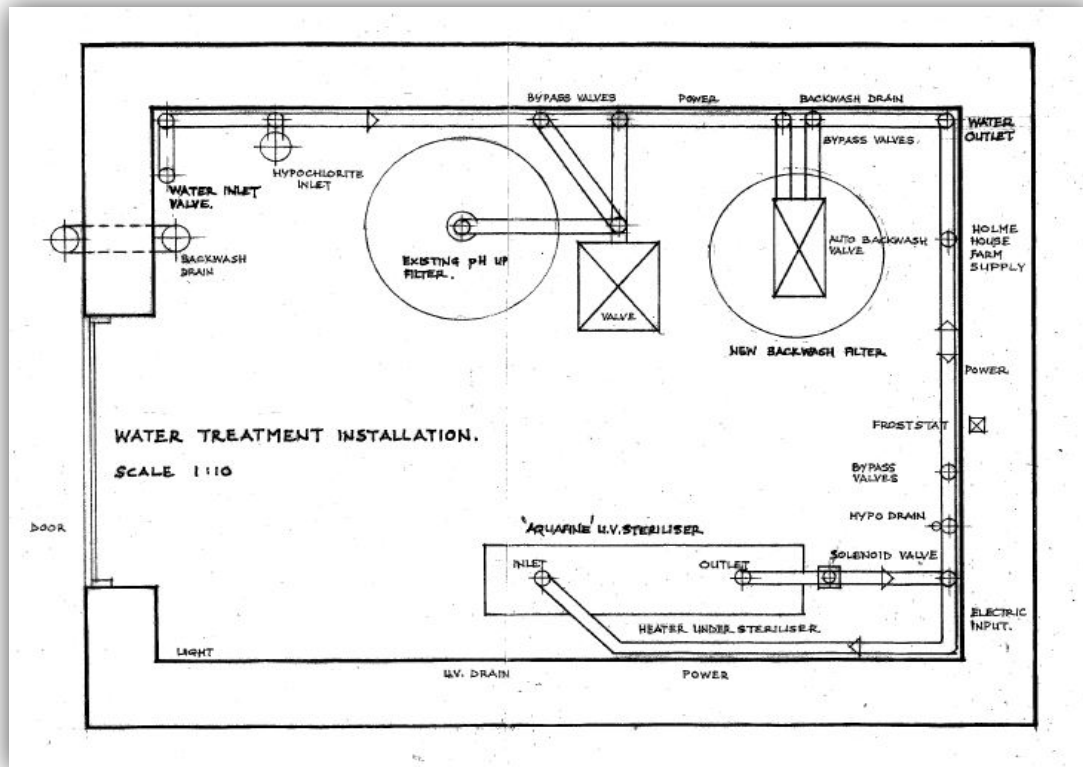

Brief outline of the treatment process from raw water to property taps

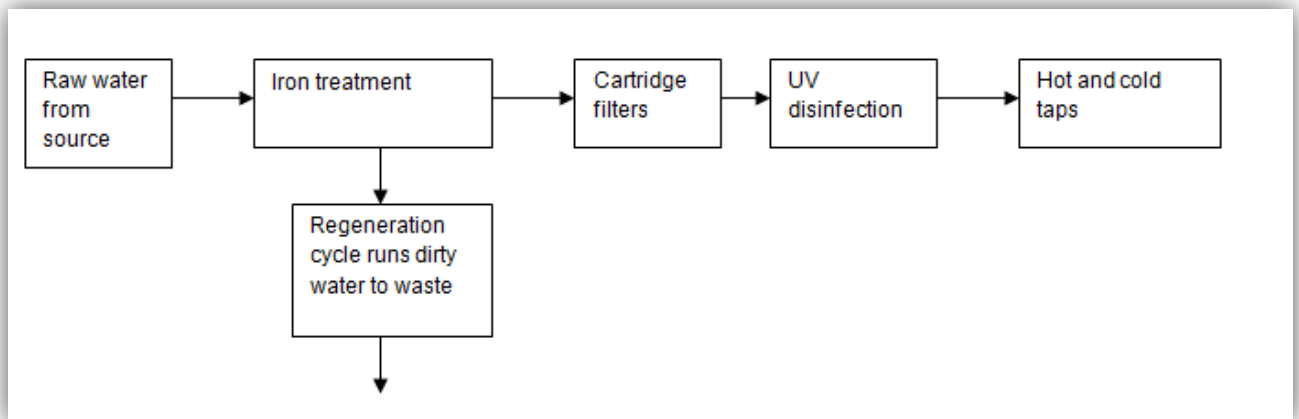

For further information on the risk assessment process and the type/format of the information that they may require please contact your local authority.